

# KTRSE TESTA RIDOTTA CORPO SEMI-ESAGONALE IN ACCIAIO INOX

## RHH-IHB/SS REDUCE HEX HEAD INNER-HEX BODY STAINLESS STEEL

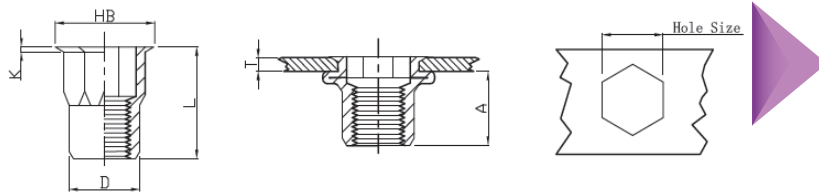

Unit: mm

THREAD	P/N	LD P/N	T (grip range) Min Max	A Ref	Hole size +0.10	D +0.07 -0.1	HB +/-0,3	K +/-0,2	L +/-0,3
M3	RHH-IHB/SS-0315	KTRSEM3C2	0.5-1.5	5,5	5,0	4,9	6,0	0,5	9,0
M3	RHH-IHB/SS-0325	KTRSEM3L2	1.5-2.5	5,5	5,0	4,9	6,0	0,5	11,0
M4	RHH-IHB/SS-0420	KTRSEM4C2	0.5-2.0	8,0	6,0	5,9	7,0	0,5	12,0
M4	RHH-IHB/SS-0440	KTRSEM4L2	2.0-4.0	8,0	6,0	5,9	7,0	0,5	14,0
M5	RHH-IHB/SS-0525	KTRSEM5C2	0.5-2.5	8,2	7,0	6,9	8,0	0,5	13,0
M5	RHH-IHB/SS-0540	KTRSEM5L2	2.5-4.0	8,2	7,0	6,9	8,0	0,5	15,0
M6	RHH-IHB/SS-0630	KTRSEM6C2	1.0-3.0	10,7	9,0	8,9	10,0	0,6	16,0
M6	RHH-IHB/SS-0650	KTRSEM6L2	3.0-5.0	10,7	9,0	8,9	10,0	0,6	18,0
M8	RHH-IHB/SS-0835	KTRSEM8C2	1.0-3.5	11,2	11,0	10,9	12,0	0,65	17,5
M8	RHH-IHB/SS-0850	KTRSEM8L2	3.5-5.0	11,2	11,0	10,9	12,0	0,65	19,5
M10	RHH-IHB/SS-1040(13H)	KTRSEM10C2/13	1.0-4.0	13,5	13,0	12,9	14,5	0,75	21,0
M10	RHH-IHB/SS-1030(12H)	KTRSEM10C2/12	1.0-4.0	13,5	12,0	11,9	13,0	0,8	18,0
M10	RHH-IHB/SS-1050(13H)	KTRSEM10L2/13	4.0-5.5	13,5	13,0	12,9	14,5	0,75	23,0
M12	RHH-IHB/SS-1240(16H)	KTRSEM12C2/16	1.0-4.0	14,8	16,0	15,9	17,5	0,8	24,0
M12	RHH-IHB/SS-1260(16H)	KTRSEM12L2/16	4.0-6.0	14,8	16,0	15,9	17,5	0,8	27,0

# KTRSEC TESTA RIDOTTA CORPO SEMI-ESAGONALE IN ACCIAIO INOX CHIUSI

## RHH-IHBC/SS REDUCE HEAD INNER-HEX BODY CLOSE END

STAINLESS STEEL

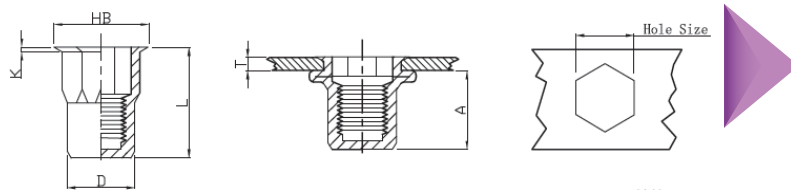

Unit: mm

THREAD	P/N	LD P/N	T (grip range) Min Max	A Ref	Hole size +0.10	D +0.07 -0.1	HB +/-0,3	K +/-0,2	L +/-0,3
M3	RHH-IHBC/SS-0315	KTRSECM3C2	0.5-1.5		5,0	4,9	6,0	0,5	13,0
M3	RHH-IHBC/SS-0325	KTRSECM3L2	1.5-2.5		5,0	4,9	6,0	0,5	15,0
M4	RHH-IHBC/SS-0420	KTRSECM4C2	0.5-2.0	11,5	6,0	5,9	7,0	0,5	15,5
M4	RHH-IHBC/SS-0440	KTRSECM4L2	2.0-4.0	11,5	6,0	5,9	7,0	0,5	17,5
M5	RHH-IHBC/SS-0525	KTRSECM5C2	0.5-2.5	13,5	7,0	6,9	8,0	0,5	18,0
M5	RHH-IHBC/SS-0545	KTRSECM5L2	2.5-4.0	13,5	7,0	6,9	8,0	0,6	20,0
M6	RHH-IHBC/SS-0630	KTRSECM6C2	0.5-3.0	15,8	9,0	8,9	10,0	0,6	21,5
M6	RHH-IHBC/SS-0655	KTRSECM6L2	3.0-5.0	15,8	9,0	8,9	10,0	0,6	23,0
M8	RHH-IHBC/SS-0835	KTRSECM8C2	1.0-3.5	18,2	11,0	10,9	12,0	0,7	24,0
M8	RHH-IHBC/SS-0860	KTRSECM8L2	3.5-5.5	18,2	11,0	10,9	12,0	0,65	26,0
M10	RHH-IHBC/SS-1040(13H)	KTRSECM10C2/13	1.0-4.0	23,2	13,0	12,9	14,5	0,80	30,5
M10	RHH-IHBC/SS-1060(13H)	KTRSECM10L2/13	4.0-5.5	23,2	13,0	12,9	14,5	0,9	33,0
M12	RHH-IHBC/SS-1260(16H)	KTRSECM12C2/16	2.0-6.0	32,8	16,0	15,9	20,0	0,85	37,9